

4-Post Heavy Truck

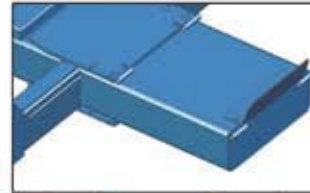

Optional Bridge Jacks



Optional Runway Extensions



Optional DP-30 Rolling Oil Drain



Rugged Construction



Optional Air/Electric Work Station

Features

- 18,000 and 27,000 pound lifting capacity
- Runways include rail-kit for optional accessories
- Electric/hydraulic power system
- Single hydraulic cylinder mounted underneath runway
- Internal "Anti-Sway" slider blocks in each column
- Features heavy-duty, 3/4" aircraft cable
- Oversized sheave diameter reduces cable fatigue
- Rugged 4" main sheave axes
- Multi-position safety locks in each column
- Multi-position, adjustable height safety locks in each column
- Ramps feature non-skid surface
- Push-button safety release
- Runways adjust for different tread widths
- Optional drive-thru ramps available
- Optional 9K, 12K, 15K-pound capacity bridge jacks available

FOUR-POST MODELS / HEAVY-DUTY

| MODEL | HD-18 | HD-27 | HD-27X |
|---------------------------------|------------------------|----------------------|----------------------|
| Lifting Capacity | 18,000 lbs. / 8165 Kg. | 27,000 lbs. / 12,247 | 27,000 lbs. / 12,247 |
| Max Capacity / Front Axle | 9,000 lbs. / 4082 Kg. | 13,500 lbs. / 6,124 | 13,500 lbs. / 6,124 |
| Max Capacity / Rear Axle | 9,000 lbs. / 4082 Kg. | 13,500 lbs. / 6,124 | 13,500 lbs. / 6,124 |
| A - Overall Width | 154" / 3912 mm. | 154" / 3912 mm. | 154" / 3912 mm. |
| B - Outside Length | 201" / 5105 mm. | 257" / 6528 mm. | 317" / 8052 mm. |
| C - Overall Length | 241" / 6121 mm. | 297" / 7544 mm. | 357" / 9068 mm. |
| D - Height of Columns | 93" / 2362 mm. | 93" / 2362 mm. | 93" / 2362 mm. |
| E - Min. Runway Height | 8-1/2" / 216 mm. | 8-1/2" / 216 mm. | 8-1/2" / 216 mm. |
| F - Max. Rise | 60" / 1524 mm. | 60" / 1524 mm. | 60" / 1524 mm. |
| G - Max. Lifting Height | 68-1/2" / 1740 mm. | 68-1/2" / 1740 mm. | 68-1/2" / 1740 mm. |
| H - Width Between Columns | 134" / 3404 mm. | 134" / 3404 mm. | 134" / 3404 mm. |
| I - Runway Width | 22" / 569 mm. | 22" / 569 mm. | 22" / 569 mm. |
| J - Width Between Runways (*) | 965 mm. - 1422 mm. | 965 mm. - 1422 mm. | 965 mm. - 1422 mm. |
| K - Length of Runways | 203" / 5156 mm. | 263" / 6680 mm. | 323" / 8204 mm. |
| Min. Wheelbase @ Rated Capacity | 145" / 3683 mm. | 185" / 4699 mm. | 230" / 5842 mm. |
| Min. Wheelbase @ 75% Capacity | 125" / 3175 mm. | 160" / 4064 mm. | 195" / 4953 mm. |
| Min. Wheelbase @ 50% Capacity | 105" / 2667 mm. | 135" / 3429 mm. | 165" / 4191 mm. |
| Min. Wheelbase @ 25% Capacity | 85" / 2159 mm. | 110" / 2794 mm. | 130" / 3302 mm. |
| Locking Positions | 9 | 9 | 9 |
| Lock Spacing | Every 6" / 152 mm. | Every 6" / 152 mm. | Every 6" / 152 mm. |
| Lifting Time | 75 Seconds | 75 Seconds | 75 Seconds |
| Standard Motor (**) | 220 VAC / 60 Hz. | 220 VAC / 60 Hz. | 220 VAC / 60 Hz. |

* This dimension may be limited with the addition of rolling jacks. See rolling jack specifications on separate page.

** Special Voltages Available Upon Request

The design, material and specifications are subject to change without notice.



BendPak Inc.
is a member of the
Automotive Lift Institute

Dimensions

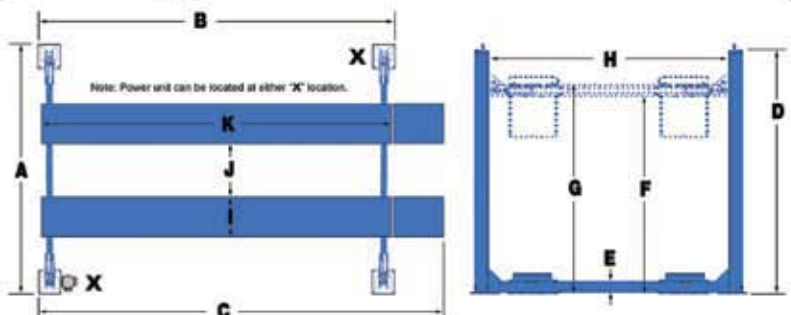

4-Post Super Duty



Shown with optional Bridge Jacks.



Optional Bridge Jacks

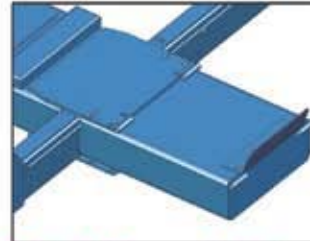

Optional Runway Extensions



Optional DP-30 Rolling Oil Drain



Rugged Construction



Optional Air/Electric Work Station

Features

- 35,000 - 40,000 lbs. lifting capacities
- Runways include rail kit for optional accessories
- Electric/hydraulic power system
- Single hydraulic cylinder mounted under runway
- Internal "Anti-Sway" slider blocks in each column
- Features heavy-duty, 7/8" aircraft cable
- Oversized self-lubricating cable rollers
- Rugged 4" main sheave axles
- Multi-position, adjustable height safety locks in each column
- Ramps feature non-skid surface
- Push-button safety release
- Runways adjust for different tread widths
- Optional drive-thru ramps available
- Optional 15K-25K pound capacity Bridge jacks

FOUR-POST MODELS / SUPER-DUTY

| MODEL | HD-35 | HD-35X | HD-40 | HD-40X |
|---------------------------------|----------------------|----------------------|----------------------|----------------------|
| Lifting Capacity | 35,000 lbs. / 15,876 | 35,000 lbs. / 15,876 | 40,000 lbs. / 18,144 | 40,000 lbs. / 18,144 |
| Max Capacity / Front Axle | 17,500 lbs. / 7,938 | 17,500 lbs. / 7,938 | 20,000 lbs. / 9,072 | 20,000 lbs. / 9,072 |
| Max Capacity / Rear Axle | 17,500 lbs. / 7,938 | 17,500 lbs. / 7,938 | 20,000 lbs. / 9,072 | 20,000 lbs. / 9,072 |
| A - Overall Width | 154" / 3912 mm. | 154" / 3912 mm. | 154" / 3912 mm. | 154" / 3912 mm. |
| B - Outside Length | 257" / 6528 mm. | 317" / 8052 mm. | 257" / 6528 mm. | 317" / 8052 mm. |
| C - Overall Length | 297" / 7544 mm. | 357" / 9068 mm. | 297" / 7544 mm. | 357" / 9068 mm. |
| D - Height of Columns | 93" / 2362 mm. | 93" / 2362 mm. | 93" / 2362 mm. | 93" / 2362 mm. |
| E - Min. Runway Height | 8-1/2" / 216 mm. | 8-1/2" / 216 mm. | 8-1/2" / 216 mm. | 8-1/2" / 216 mm. |
| F - Max. Rise | 60" / 1524 mm. | 60" / 1524 mm. | 60" / 1524 mm. | 60" / 1524 mm. |
| G - Max. Lifting Height | 68-1/2" / 1740 mm. | 68-1/2" / 1740 mm. | 68-1/2" / 1740 mm. | 68-1/2" / 1740 mm. |
| H - Width Between Columns | 134" / 3404 mm. | 134" / 3404 mm. | 134" / 3404 mm. | 134" / 3404 mm. |
| I - Runway Width | 28" / 711 mm. | 28" / 711 mm. | 28" / 711 mm. | 28" / 711 mm. |
| J - Width Between Runways (*) | 36" - 47" | 36" - 47" | 36" - 47" | 36" - 47" |
| K - Length of Runways | 914 mm. - 1194 mm. | 914 mm. - 1194 mm. | 914 mm. - 1194 mm. | 914 mm. - 1194 mm. |
| Min. Wheelbase @ Rated Capacity | 263" / 6680 mm. | 323" / 8204 mm. | 263" / 6680 mm. | 323" / 8204 mm. |
| Min. Wheelbase @ 75% Capacity | 185" / 4699 mm. | 230" / 5842 mm. | 185" / 4699 mm. | 230" / 5842 mm. |
| Min. Wheelbase @ 50% Capacity | 160" / 4064 mm. | 195" / 4953 mm. | 160" / 4064 mm. | 195" / 4953 mm. |
| Min. Wheelbase @ 25% Capacity | 135" / 3429 mm. | 165" / 4191 mm. | 135" / 3429 mm. | 165" / 4191 mm. |
| Locking Positions | 9 | 9 | 9 | 9 |
| Lock Spacing | Every 6" / 152 mm. | Every 6" / 152 mm. | Every 6" / 152 mm. | Every 6" / 152 mm. |
| Lifting Time | 75 Seconds | 75 Seconds | 75 Seconds | 75 Seconds |
| Standard Motor (**) | 220 VAC / 60 Hz. | 220 VAC / 60 Hz. | 220 VAC / 60 Hz. | 220 VAC / 60 Hz. |

* This dimension may be limited with the addition of rolling jacks. See rolling jack specifications on separate page.

** Special Voltages Available Upon Request

The design, material and specifications are subject to change without notice.



BendPak Inc.
is a member of the
Automotive Lift Institute

Dimensions

